

A0 INSTALLATION DRAWING

IF THIS DOCUMENT IS PRINTED IN HARD COPY, IT IS FOR INFORMATION USE ONLY AND THEREFORE IS NOT SUBJECT TO UPDATING CONTROLS. ALWAYS REFER TO SOLIDWORKS VIEWER FOR LATEST ISSUE



THIS DRAWING IS CONFIDENTIAL AND IS SUPPLIED ON THE EXPRESS CONDITION THAT IT SHALL NOT BE LOANED OR COPIED OR DISCLOSED TO ANY OTHER PERSON OR USED FOR ANY OTHER PURPOSE WITHOUT THE WRITTEN CONSENT OF AP RACING LTD.



AP Racing
 Wheeler Road
 Coventry
 CV3 4LB
 Tel: +44 (0)24 7663 9595
 Fax: +44 (0)24 7663 9559
 e-mail: sales@aprac.com
 © AP Racing Ltd. 2005 Web site: HTTP://www.aprac.com

ENSURE THAT MOST OF THE BASE IS SUPPORTED WHEN FITTED TO THE CAR.

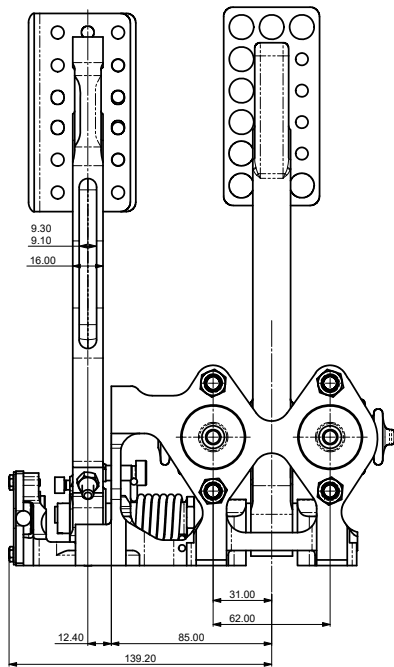
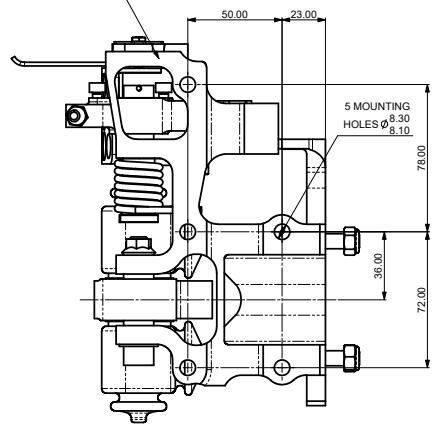

GENERAL DESCRIPTION

THIS PEDAL BOX IS A GENERIC RACING PEDAL BOX DESIGN, DESIGNED FOR COMFORT AND CONTROL. THIS UPDATED PEDAL BOX HAS A NEW OPTIMISED MACHINED FROM BILLET BASEPLATE AND PEDALS. THE THROTTLE HAS BEEN UPDATED TO ADD ADDITIONAL FEATURES TO AID CONNECTION TO BELL CRANKS AND CABLES.

FEATURES

- OPTIMISED, LIGHTWEIGHT, MACHINED FROM BILLET BASE PLATE.
- OPTIMISED, LIGHTWEIGHT BRAKE PEDAL, WITH IMPROVED TWIST DISPLACEMENT.
- NEW THROTTLE PEDAL WITH ADDITIONAL FEATURES.
- ADJUSTABLE RATIO PEDALS.
- ALL THREADS ARE METRIC, EXCEPT THOSE MENTIONED BELOW.
- Ø10 BALANCE BAR
- ADJUSTABLE STOPS ON THROTTLE PEDALS.
- PEDAL BOX WEIGHT IS 1.9Kg
 BALANCE BAR ADJUSTER CABLE WEIGHT 236 g
 (CP2623 MASTER CYLINDERS APPROX 0.31Kg EACH)
- CABLE ADJUSTER INCLUDED.
- ALL PEDALS HAVE BALL BEARING PIVOTS.
- OPTIONAL ROTARY HALL EFFECT SENSOR ON THROTTLE, SEE SHEET 2 FOR DETAILS

PART NUMBERS	CLEVIS THREADS		THROTTLE SENSOR	
	METRIC M8x1.25	IMPERIAL 5/16" UNF	INCLUDED	NOT INCLUDED
CP5500-625MTS	✓	✗	✓	✗
CP5500-625M	✓	✗	✗	✓
CP5500-625UTS	✗	✓	✓	✗
CP5500-625U	✗	✓	✗	✓

BORE SIZE	BRAKE PEDAL
Ø14.0mm (0.551")	CP2623-88PRM088
Ø15.0mm (0.591")	CP2623-89PRM088
Ø15.8mm (0.625") 5/8"	CP2623-90PRM088
Ø16.8mm (0.661")	CP2623-905PRM088
Ø17.8mm (0.700")	CP2623-91PRM088
Ø19.1mm (0.750") 3/4"	CP2623-92PRM088
Ø20.6mm (0.842") 13/16"	CP2623-93PRM088
Ø22.2mm (0.875") 7/8"	CP2623-94PRM088
Ø23.8mm (0.937") 15/16"	CP2623-95PRM088
Ø25.4mm (1.000")	CP2623-96PRM088

THIS TABLE SHOWS THE RECOMMENDED PUSHROD LENGTHS FOR CYLINDERS IN THIS BOX.

IF YOU ARE ORDERING THE CP5500-505UNF, THEN MAKE SURE YOU ORDER YOUR CYLINDERS WITH THE "PRT" EXTENSION AND NOT THE "PRM", eg CP2623-91PRT088

CP2623 CYLINDERS HAVE IMPERIAL THREADS ON THE INLET AND OUTLET. FOR METRIC THREADS ORDER CP5623 VERSIONS INSTEAD.

CYLINDERS WITH LONGER PUSHRODS CAN BE CUT DOWN.

FOR OPTIONAL EXTRAS & SPARES SEE SHEET 2

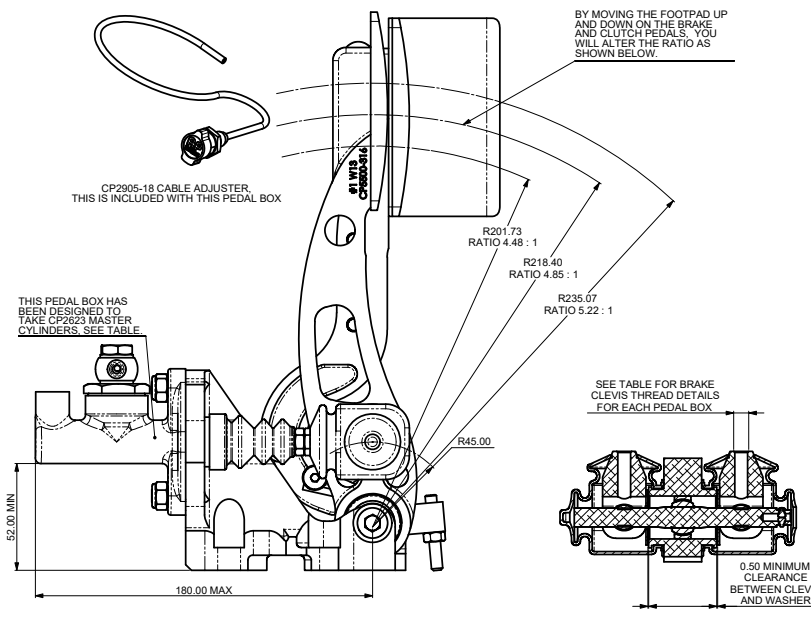
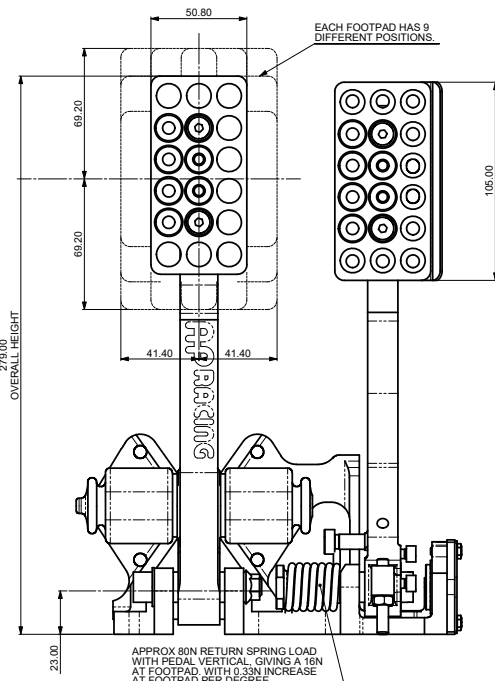
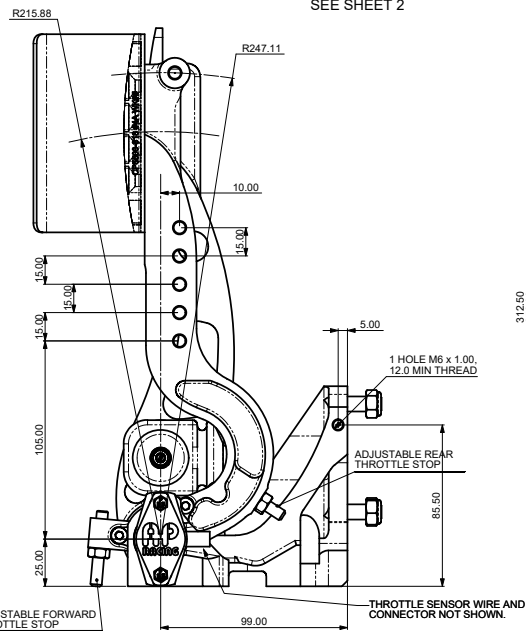

Rev	Alterations		Z	Date
	Date & No.	Particulars		
2	05/06/2014	FIRST ISSUE		
3	10/02/16	SHEET 3: ITEM 16 - CP5500-373 WAS CP5500-331 ITEM 22 - CP5500-374 WAS CP5500-336 BOLT AND BUSH NOTE ADDED		
4	14/09/16	SHEET 1: BRAKE CLEVIS THREAD NOTE UPDATED SHEET 3: ITEM 16: CP5500-379 WAS -373		
5	10/08/20	NEW TIPS AND DEBRIS SLEEVE ADDED - VIEWS UPDATED TO REFLECT THIS CHANGE SHEET 3: ITEM 27 - CP5500-383 WAS CP5500-364 ITEM 29 - CP5500-385 WAS CP5500-369		
6	09/05/2022	SHEET 2: ELECTRICAL CONNECTION NOTE UPDATED TO NEW SPEC. GRAPH DATA TO TBC NOTE REMOVED DTM PLUG REMOVED		
7	18/11/2022	SHEET 3: ITEM 13 - 1x CP5500-390 WAS 2x CP7000-110 ITEM 28 - 2x CP4333-148 WAS 2x CP4028-114		

SCALE 1:1	SHEET 1 OF 3
DRAWN Steve Thomas	
APPROVED	
DERIVED FROM	
TITLE	GENERIC FLOOR MTG PEDAL BOX
DRG NO.	CP5500-625CD

A0 INSTALLATION DRAWING

IF THIS DOCUMENT IS PRINTED IN HARD COPY, IT IS FOR INFORMATION USE ONLY AND THEREFORE IS NOT SUBJECT TO UPDATING CONTROLS. ALWAYS REFER TO SOLIDWORKS VIEWER FOR LATEST ISSUE



THIS DRAWING IS CONFIDENTIAL AND IS SUPPLIED ON THE EXPRESS CONDITION THAT IT SHALL NOT BE LOANED OR COPIED OR DISCLOSED TO ANY OTHER PERSON OR USED FOR ANY OTHER PURPOSE WITHOUT THE WRITTEN CONSENT OF AP RACING LTD.

AP RACING
 AP Racing Ltd. 2005
 AP Racing
 Wheler Road
 Coventry
 CV3 4LB
 Tel: +44 024 7663 9595
 Fax: +44 024 7663 9559
 e-mail: sales@apracings.co.uk
 Web site: HTTP://www.apracings.com

OPTIONAL EXTRAS

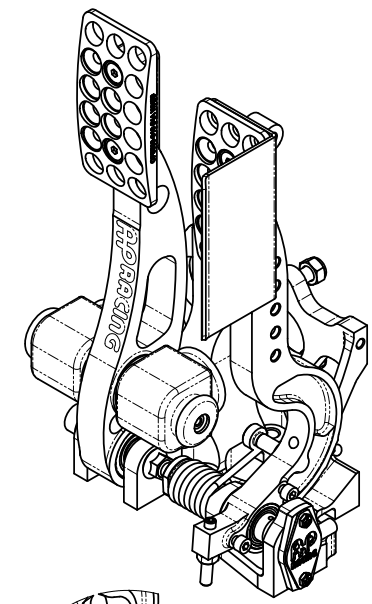

THROTTLE RELEASE KIT
 PART NUMBER: CP5500-44
 SOLD SEPARATELY

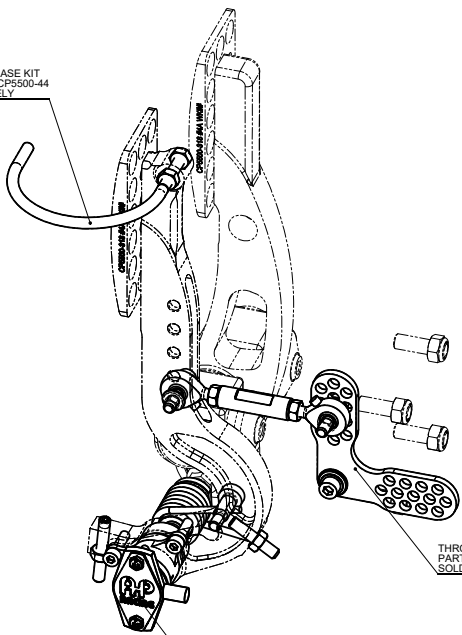

THROTTLE LINKAGE KIT
 PART NUMBER: CP5500-43
 SOLD SEPARATELY

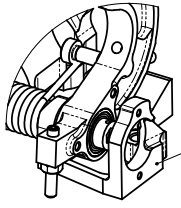

THE CP5500-625M & CP5500-625U PEDAL BOXES WILL BE BUILT AS SHOWN HERE.

THROTTLE SENSOR DETAIL NON CONTACT ROTARY HALL EFFECT SENSOR WITH DUAL REDUNDANCY

THE THROTTLE SENSOR HAS A MEASURING RANGE OF 30°. THIS ANGLE WAS SELECTED TO PROVIDE A HIGH RESOLUTION OF DATA FROM THE SENSOR, AND BECAUSE THE TYPICAL TRAVEL OF A THROTTLE PEDAL IS WITHIN THIS, THE PEDAL WITH ITS STOPS ARE CAPABLE OF A MUCH BIGGER RANGE (20.5° FORWARD FROM VERTICAL, 27.5° BACKWARDS FROM VERTICAL). THE PEDAL BOX AS STANDARD WILL BE SET AT 4° FORWARD, TO 24° BACK. IF YOU NEED A DIFFERENT RANGE, ALTER THE FORWARD STOP, ALTER THE BACK STOP (KEEP THE RANGE TO WITHIN 30°), THEN ROTATE THE SENSOR TO AN ANGLE WHERE IS CAN READ YOUR NEW RANGE.

- Electrical**
- Measurement range: 30° (BOTH CHANNELS)
 - Supply voltage: 5-±0.5 Vdc
 - Over voltage protection: up to 10 Vdc
 - Maximum supply current: <12.5 mA each independent supply (<25mA total)
 - Reverse polarity protection: Yes
 - Short circuit protection: Yes
 - Output to GND: Yes
 - Output to supply: Yes
 - Power-on settlement time: <1 s
 - Resolution: 0.025% of measurement range (12 Bit)
 - Non-linearity: <±0.4 %
 - Temperature coefficient: <±30 ppm/°C

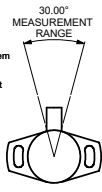

- Analog Output**
- Voltage output range Vdc: Ratiometric output voltage - 4% to 98% of Vs over measurement
 - Monotonic range Vdc: 0.05 (1%) and 4.95 (99%) nominal
 - Load resistance: 10k minimum (resistive to GND)
 - Output noise: <1 mVrms
 - Input/output delay: <2 ms Typ.
 - Output direction: Channel 1 - CW, Channel 2 - ACW

- Mechanical**
- Mechanical angle: 360°, continuous
 - Maximum rotational speed: 3600°/sec
 - Weight: <45 g
 - Mounting: Use 2 x M4 socket head cap screws and M4 washer - maximum tightening torque 2.0Nm.
 - Phasing: When magnet ident mark is facing toward the sensor and cable exit, output is at mid travel. The sensor housing allows for ±10° adjustment via the mounting flange slots.

- Environmental**
- Protection class: IP68 (to 2m depth for 2 hours) and IP69K
 - Life: This product has no contacting parts.
 - Dither life: Contactless - no degradation due to shaft dither
 - Operational temperature: -40°C to +120°C
 - Storage temperature: -40°C to +120°C
 - Vibration: BS EN 60068-2-64: 2008 Sec 8.4 (31.4gn rms) 20 to 2000Hz Random
 - Shock: 2500g
 - EMC Immunity level: BS EN 61000-4-3:1999, to 100V/m, 80MHz to 1GHz and 1.4GHz to 2.7GHz (2004/108/EC)

If the maximum operating temperature is exceeded, the voltage regulator will shut down to protect the device from overheating

- OTHER**
- Cable length: 0.5m
 - Electrical Connections: 6-core cable, DR-25 jacket 28 AWG Spec 44A wires
 - Minimum bend radius is 5x the cable OD for static applications (20.5mm) and 10x the cable OD for dynamic applications (41mm)
- Sensor wire Arrangement & description**
- BLUE - Channel 2
 - WHITE - Channel 2
 - GREEN - Channel 2
 - RED - Channel 1
 - YELLOW - Channel 1
 - BLACK - Channel 1

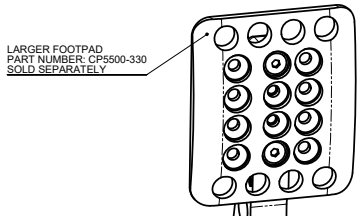
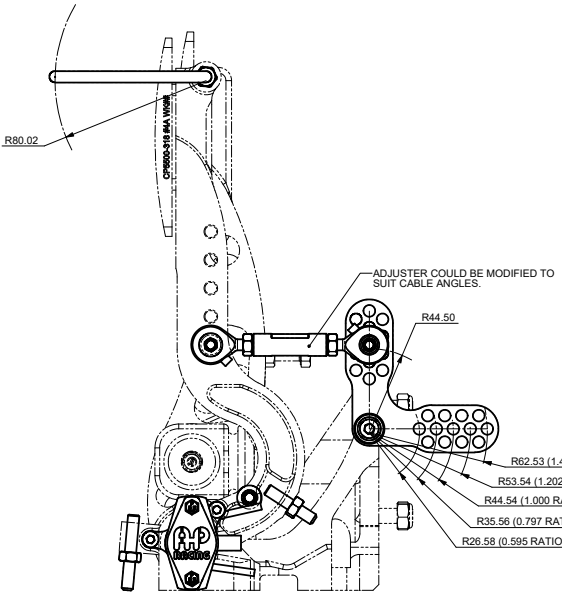
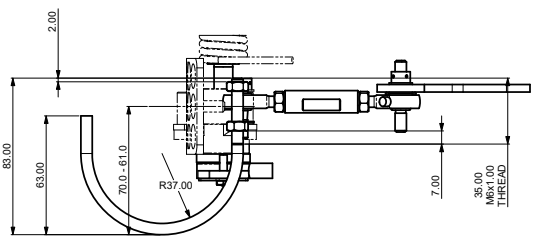
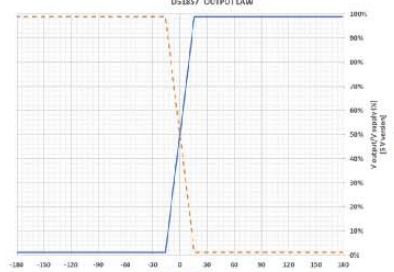

LARGER FOOTPAD
 PART NUMBER: CP5500-330
 SOLD SEPARATELY

ONLY THE BRAKE PEDAL HAS BEEN TESTED WITH THIS ITEM FITTED. IT SHOULD NOT BE FITTED TO THE THROTTLE PEDAL.

Rev	Date & No.	Alterations	Particulars	Drawn	Checked
0			SEE SHEET 1 FOR ISSUE INFORMATION.		

SCALE 1:1 SHEET 2 OF 3
 DRAWN: Steve Thomas
 APPROVED:
 DERIVED FROM:
 TITLE: GENERIC FLOOR MTG PEDAL BOX
 DRG NO: CP5500-625CD

A0 INSTALLATION DRAWING

IF THIS DOCUMENT IS PRINTED IN HARD COPY, IT IS FOR INFORMATION USE ONLY AND THEREFORE IS NOT SUBJECT TO UPDATING CONTROLS. ALWAYS REFER TO SOLIDWORKS VIEWER FOR LATEST ISSUE



THIS DRAWING IS CONFIDENTIAL AND IS SUPPLIED ON THE EXPRESS CONDITION THAT IT SHALL NOT BE LOANED OR COPIED OR DISCLOSED TO ANY OTHER PERSON OR USED FOR ANY OTHER PURPOSE WITHOUT THE WRITTEN CONSENT OF AP RACING LTD.

AP RACING
 AP Racing
 Wheeler Road
 Coventry
 CV3 4LB
 Tel: +44 024 7663 9595
 Fax: +44 024 7663 9559
 e-mail: sales@apracings.co.uk
 © AP Racing Ltd. 2005 Web site: HTTP://www.apracings.com

SPARES LIST

ITEM NO.	PART NUMBER	DESCRIPTION	Metric Version Quantity	Imperial Version Quantity
1	CP5500-360	BASE PLATE	1	1
2	CP5500-133	STUD M8x1.25, 28.0 LONG	4	4
3	CP5518-127	SPACER	3	3
4	CP5500-40	BRAKE PEDAL SUB-ASSY	1	1
5	CP5500-124	WASHER	2	2
6	CP5500-312	CLEVIS - METRIC	2	-
7	CP5500-108	BARREL NUT	2	2
8	CP5500-150	RUBBER BOOT	2	2
9	CP5500-148	SNAP RING 0.4375"	2	2
10	CP5500-113st	SCREW M4 x 5	2	2
11	CP5500-105	BALANCE BAR	1	1
12	CP5500-318	FOOTPAD	2	2
13	CP5500-390	SENSOR BACK PLATE	1	1
14	CP4350-106	M6 x 14 SCREW, COUNTERSUNK	4	4
15	CP5500-46	THROTTLE PEDAL SUB-ASSY	1	1
16	CP5500-379	M10x57x1.50 BOLT	1	1
17	CP5500-338	M6 SCREW x 40, FLAT GRUB	1	1
18	ME21001	M6 x 1.00 NUT	2	2
19	CP5500-324	M6 SCREW x 30, FLAT GRUB	1	1
20	CP7033-111	M6 SCREW, Ø8 SHOULDER	1	1
21	CP5500-329	THROTTLE GUARD	1	1
22	CP5500-374	SPRING SUPPORT BUSH	1	1
23	CP5500-365	TORSION SPRING	1	1
24	CP5427-101	M10 KAYLOCK NUT	1	1
25	CP5200-173	M10x1.50 CAP HEAD BOLT	1	1
26	CP4612-109	M5 x 0.80 CAP HEAD	2	2
27	CP5500-383	DEBRIS SLEEVE	1	1
28	CP4333-148	M4 x 0.7 HEX HEAD SCREW, 14.00 LONG	2	2
29	CP5500-382	ROTARY SENSOR	1	1
30	CP5500-345	CLEVIS - UNF	-	2
31	CP5500-339	SPHERICAL BEARING	1	1
32	CP5500-363	MAGNET HOLDER	1	1
33	CP5500-346	M8 NYLOC NUT	4	4
34	CP5200-150	WASHER	1	1

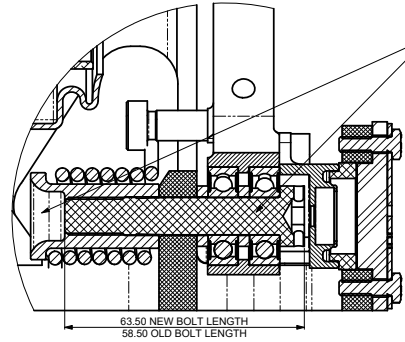

NOTE:
 THROTTLE PIVOT BOLT (CP5500-331) AND BUSH (CP5500-366) REPLACED AT ISSUE 3. FOR SPARES, PLEASE ORDER BOLT (CP5500-373) AND BUSH (CP5500-374) TOGETHER. NEW AND OLD PARTS ARE NOT COMPATIBLE.
 CP5500-373 REPLACED BY CP5500-379 AT ISSUE 4.

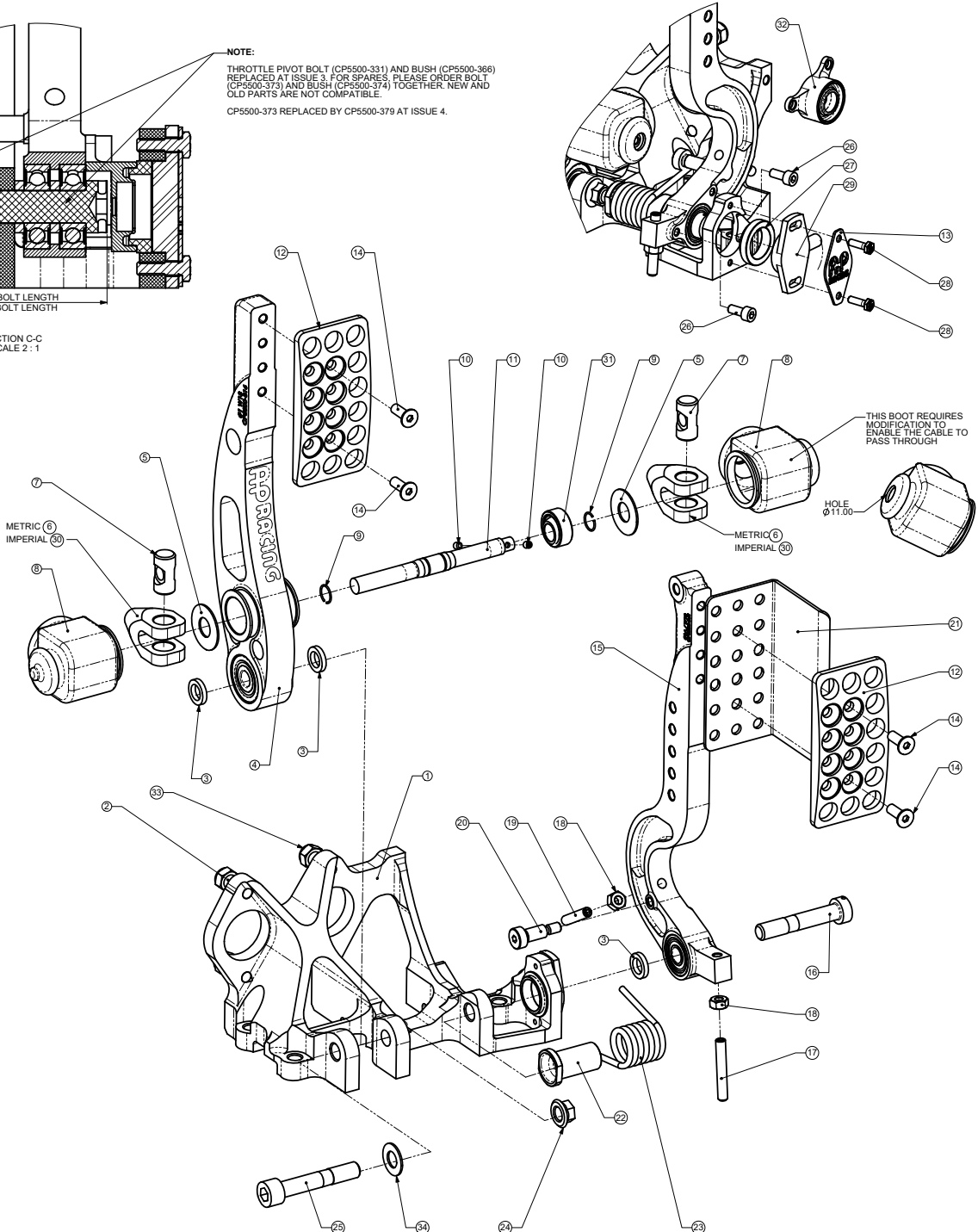

THIS BOOT REQUIRES MODIFICATION TO ENABLE THE CABLE TO PASS THROUGH

HOLE Ø11.00

METRIC Ø
IMPERIAL Ø

METRIC Ø
IMPERIAL Ø

Rev	Date & No.	Alterations	
		Particulars	Drawn
0			
1		SEE SHEET 1 FOR ISSUE INFORMATION.	

SCALE 1:1 SHEET 3 OF 3
 DRAWN Steve Thomas
 APPROVED
 DERIVED FROM
 TITLE
 GENERIC FLOOR MTG
 PEDAL BOX
 DRG NO. CP5500-625CD